

257.83 (b) (2)	REPORT OF ANNUAL INSPECTION OF CCR SURFACE IMPOUNDMENT		
	FACILITY NAME: Plant Bowen Ash Pond (AP-1)		
	OWNER/OPERATOR OF FACILITY: Georgia Power Company		
	INSPECTION DATE: November 16, 2017		
	INSPECTING ENGINEER: Patrick B. Rhodes, PE (Ga. PE License #PE024586)		
(i)	ANY CHANGES IN GEOMETRY OF THE IMPOUNDING STRUCTURE SINCE THE PREVIOUS ANNUAL INSPECTION? (IF YES, DESCRIBE):	NO	
(ii)	LOCATION AND TYPE OF EXISTING INSTRUMENTATION	SEE ATTACHED PLAN	
(ii)	MAXIMUM RECORDED READING OF EACH INSTRUMENT SINCE PREVIOUS ANNUAL INSPECTION	SEE ATTACHED TABLE	
(iii)	APPROXIMATE MINIMUM, MAXIMUM AND PRESENT DEPTH AND ELEVATION OF THE IMPOUNDED WATER SINCE PREVIOUS ANNUAL INSPECTION		
	MIN. DEPTH: 6'	MAX. DEPTH: 16'	PRESENT DEPTH: 10' (max.)
	MIN. ELEVATION: 700	MAX. ELEVATION: 710	PRESENT. ELEVATION: 704
(iii)	APPROXIMATE MINIMUM, MAXIMUM AND PRESENT DEPTH AND ELEVATION OF CCR SINCE PREVIOUS ANNUAL INSPECTION.		
	MIN. DEPTH: 14'	MAX. DEPTH: 100'	PRESENT DEPTH: 100' (max.) ⁽¹⁾
	MIN. ELEVATION: 694	MAX. ELEVATION: 780	PRESENT ELEVATION: 780
(iv)	APPROXIMATE STORAGE CAPACITY OF IMPOUNDING STRUCTURE AT TIME OF INSPECTION.	15,221,800 cy	
(v)	APPROXIMATE VOLUME OF IMPOUNDED WATER AND CCR AT TIME OF INSPECTION	WATER: 268,600 cy	CCR: 21,170,691 cy ^{(1) (2)}
(vi)	ANY APPEARANCE OF AN ACTUAL OR POTENTIAL STRUCTURAL WEAKNESS OF THE CCR UNIT, IN ADDITION TO ANY EXISTING CONDITIONS THAT ARE DISRUPTING OR HAVE THE POTENTIAL TO DISRUPT THE OPERATION AND SAFETY OF THE CCR UNIT AND APPURTENANT STRUCTURES? (IF YES, DESCRIBE):	NO	
(vii)	ANY OTHER CHANGE(S) WHICH MAY HAVE AFFECTED THE STABILITY OR OPERATION SINCE THE PREVIOUS ANNUAL INSPECTION? (IF YES, DESCRIBE):	NO	

(1) Includes approximately 6,233,497 cy of dry stack ash storage within ash pond.

(2) Cubic yard estimates are derived by qualified personnel from available information.

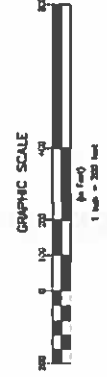

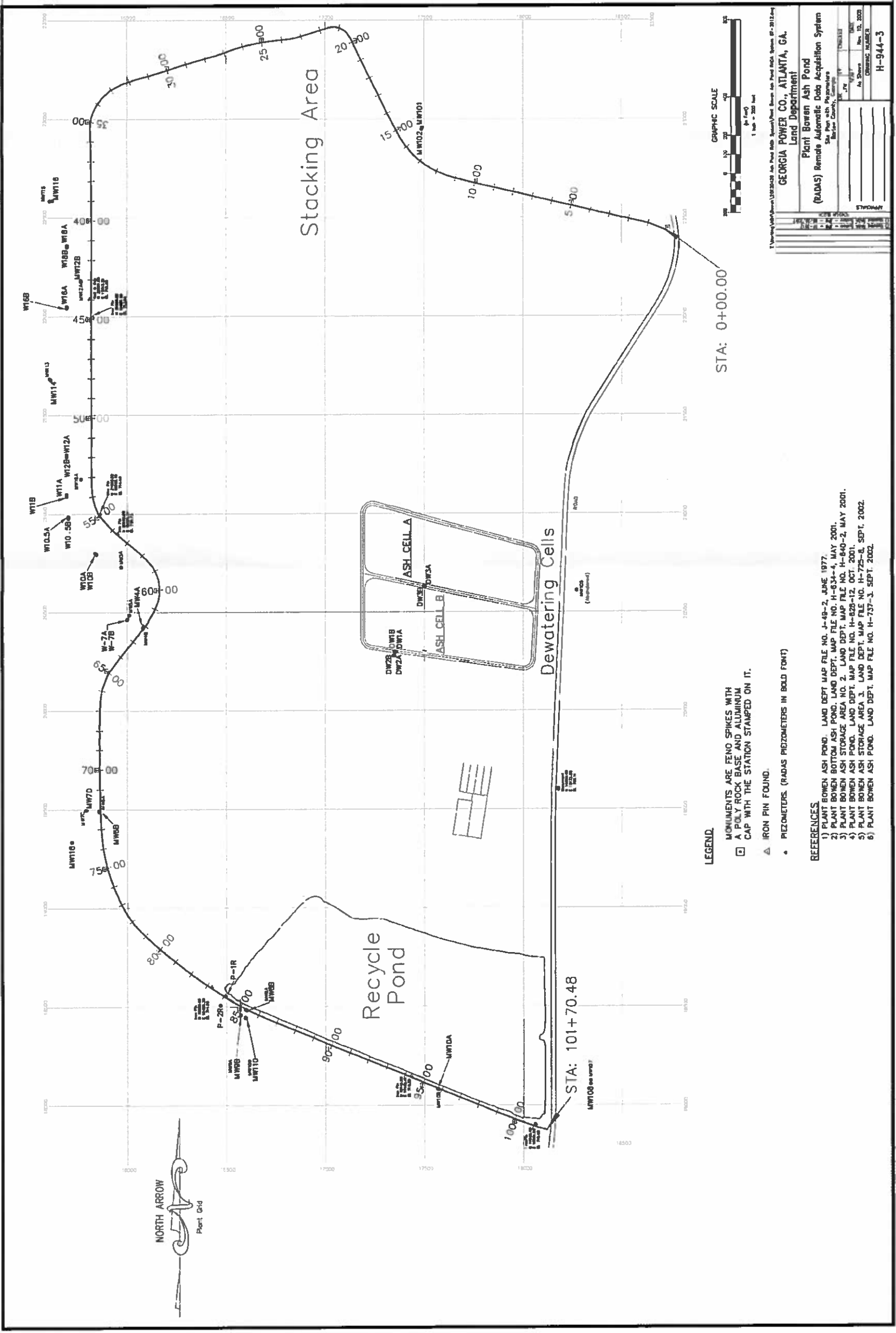

- LEGEND.**
- MONUMENTS ARE FENO SPIKES WITH A POLY ROCK BASE AND ALUMINUM CAP WITH THE STATION STAMPED ON IT.
 - IRON PIN FOUND.
 - PIEZOMETERS. (RADIIUS PIEZOMETERS IN BOLD FONT)

- REFERENCES.**
- 1) PLANT BOWEN ASH POND. LAND DEPT MAP FILE NO. J-49-2, JUNE 1977.
 - 2) PLANT BOWEN BOTTOM ASH POND. LAND DEPT. MAP FILE NO. H-834-4, MAY 2001.
 - 3) PLANT BOWEN ASH STORAGE AREA NO. 2. LAND DEPT. MAP FILE NO. H-840-2, MAY 2001.
 - 4) PLANT BOWEN ASH POND. LAND DEPT. MAP FILE NO. H-829-12, OCT. 2001.
 - 5) PLANT BOWEN ASH STORAGE AREA 3. LAND DEPT. MAP FILE NO. H-725-8, SEPT. 2002.
 - 6) PLANT BOWEN ASH POND. LAND DEPT. MAP FILE NO. H-737-3, SEPT. 2002.

GEORGIA POWER CO., ATLANTA, GA.
 Land Department

Plant Bowen Ash Pond
 (BADAS) Remote Automatic Data Acquisition System

Site Plan with Piezometers
 Bowen County, Georgia

DATE	11/11/02
BY	J.W. THRELLER
APP'D	
DATE	Nov. 12, 2002
DESIGNED BY	
CHECKED BY	

H-944-3

<u>Piezo. Name</u>	<u>Northing</u>	<u>Easting</u>	<u>Ground Elevation</u>	<u>Depth, Bottom of Casing (feet)</u>	<u>Top of Pipe, Elev. (feet)</u>	<u>Elev. Bottom of casing (feet)</u>	<u>Max. Elev. Reading Since Last Annual Inspection</u>
W-7A	20467.91	16000.8	676.53	20.08	677.48	657.40	685.9
W-7B	20463.5	15998.7	676.66	35.03	680.33	645.30	671.5
W10A	20798.7	15838.4	673.32	25.00	684.5	659.50	669.0
W-10B	20793.49	15843.8	673.39	40.00	685.9	645.90	666.2
W10.5A	20970.93	15700.3	673.39	20.04	675.14	655.10	664.4
W10.5B	20962.72	15700	673.11	35.00	676.35	641.35	664.8
W-11A	21096.22	15695.5	672.54	19.25	677.12	657.87	669.0
W-11B	21087.11	15695.4	673.15	29.95	674.65	644.70	667.4
W-12A	21297.45	15695.3	673.52	19.98	674.48	654.50	Inactive
W-12B	21287.68	15695.3	673.34	35.03	677.43	642.40	667.6
W-16A	22050.38	15695.9	672.65	15.25	676.76	661.51	Inactive
W-16B	22041.72	15695.4	671.87	38.05	674.95	636.90	661.9
W-18A	22359.7	15696.7	672.63	27.06	675.76	648.70	665.8
W-18B	22352.17	15696.1	672.59	85.26	676.86	591.60	663.0
P-1R	18554.69	16494.1	715.03	50.9	718.93	668.03	698.0
P-2R	18506.41	16468.5	698.718	38.7	700.62	661.92	691.7
MW101	22954.6	17490.9	682.49	53.26	685.31	632.05	663.2
MW102	22946.3	17488.1	683.10	115.16	684.64	569.48	657.9
MW107	18124.77	18337.7	711.80	60.96	713.84	652.88	694.7
MW108	18107.3	18337.4	711.86	88.63	714.37	625.74	696.3
MW109	18443.2	16598.4	700.727	52.64	702.54	649.9	686.5
MW110	18446.65	16594.8	700.76	76.71	704.34	627.63	688.5
MW113	21683.06	15608.9	670.76	26.92	674.23	647.31	667.1
MW114	21678.15	15614.3	671.53	70.48	674.38	603.90	661.6
MW115	22584.8	15610	671.98	26.36	674.71	648.35	663.2
MW116	22586.48	15624.1	671.69	63.54	674.11	610.57	662.0
MW118	19333.71	15720	689.91	26.22	692.94	666.72	675.3
MW3A	20729.09	15966.4	671.77	17.30	674.6	657.3	670.4
MW4A	20426.31	16080.9	714.26	56.04	714.3	658.26	670.1
MW4B	20421.39	16078.9	714.36	46.00	714.4	668.4	670.8

<u>Piezo. Name</u>	<u>Northing</u>	<u>Easting</u>	<u>Ground Elevation</u>	<u>Depth, Bottom of Casing (feet)</u>	<u>Top of Pipe, Elev. (feet)</u>	<u>Elev. Bottom of casing (feet)</u>	<u>Max. Elev. Reading Since Last Annual Inspection</u>
MW5A	20485.74	16011.6	675.12	20.40	680	659.6	670.2
MW6A	19494.75	15857.8	715.34	50.00	715.3	665.3	678.6
MW6B	19487.96	15858	715.24	56.96	715.2	658.24	677.2
MW7C	19495.53	15789.4	688.14	27.60	691.7	664.1	679.7
MW7D	19496.21	15793.5	687.91	38.30	691.2	652.90	683.6
MW8A	18486.07	16597.5	715.952	24	715.9	691.9	703.2
MW8B	18483.14	16603.1	715.959	50	715.9	665.9	703.6
MW9A	18455	16570.7	699.046	44.15	701.65	657.5	687.5
MW9B	18457.79	16571.9	699.276	44.72	702	657.28	692.1
MW10A	18081.59	17565.7	715.995	68	716	648	697.8
MW10B	18079.79	17571.9	715.758	54	715.8	661.8	697.1
MW12A	22175.11	15766.6	693.24	20.00	693.2	673.2	671.1
MW12B	22180.44	15765.9	693.02	44.95	696.1	651.15	662.9
MW16A	21175.39	15766.2	693.56	33.10	694.7	661.6	671.1
DW-1A	20296.05	17355.76	727.93	24.6	727.93	703.33	705.1
DW-1B	20298.06	17349.92	727.77	37.15	727.77	690.62	708.0
DW-2A	20276.18	17350.11	721.48	15.02	721.48	706.46	706.9
DW-2B	20276.18	17345.28	721.68	27.4	721.68	694.28	705.8
DW-3A	20629.61	17502.77	725.67	34.4	725.67	691.27	717.6
DW-3B	20630.94	17497.46	725.61	24.55	725.61	701.06	705.3

Automated Data Acquisition System Equipped



Inactive Piezometer

15695-9